

# Fence Information Sheet

A front fence can include a wall, screen, or the like abutting a street boundary, or located in the front setback area.

Front fences within the primary street setback less than 1.2m do not require Council Approval

Front fences over 1.2m in height require Council approvals and must be visually permeable from 1.2m to 1.8m. There are also other requirements if located within 1.5m of a driveway.

Visually Permeable means:-

A Wall, gate, door or fence that the vertical surface has:

- Continuous vertical or horizontal gaps of 50mm or greater width occupying not less than one third of the total surface area; or
- Continuous vertical or horizontal gaps less than 50mm in width, occupying at least one half of the total surface area in aggregate; or
- A surface offering equal or lesser obstruction to view;

As viewed directly from the street

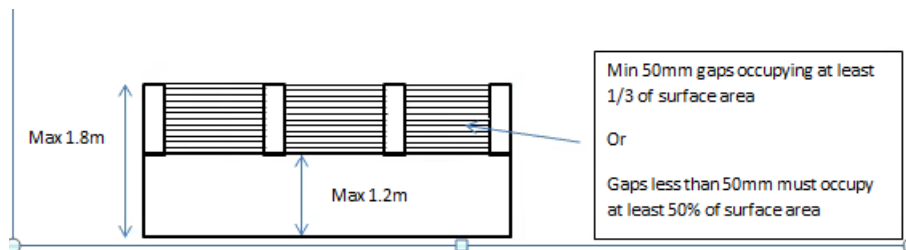

## Truncation Areas

Areas near a driveway within 1.5m of where the driveway meets the front boundary are designated as the Truncation Area as per the Residential Design Codes. These Truncation Areas ensure safety by providing unobstructed sight lines at vehicle access points.

Truncation areas shall not have Within them:

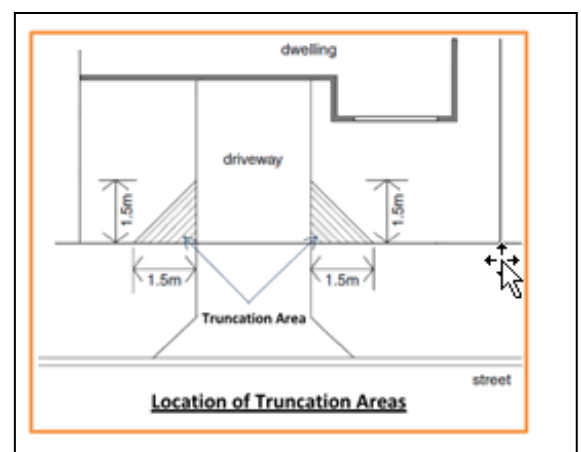

- Solid portions of wall higher than 750mm and
- More than one pier equal to or greater than 350mm by 350mm

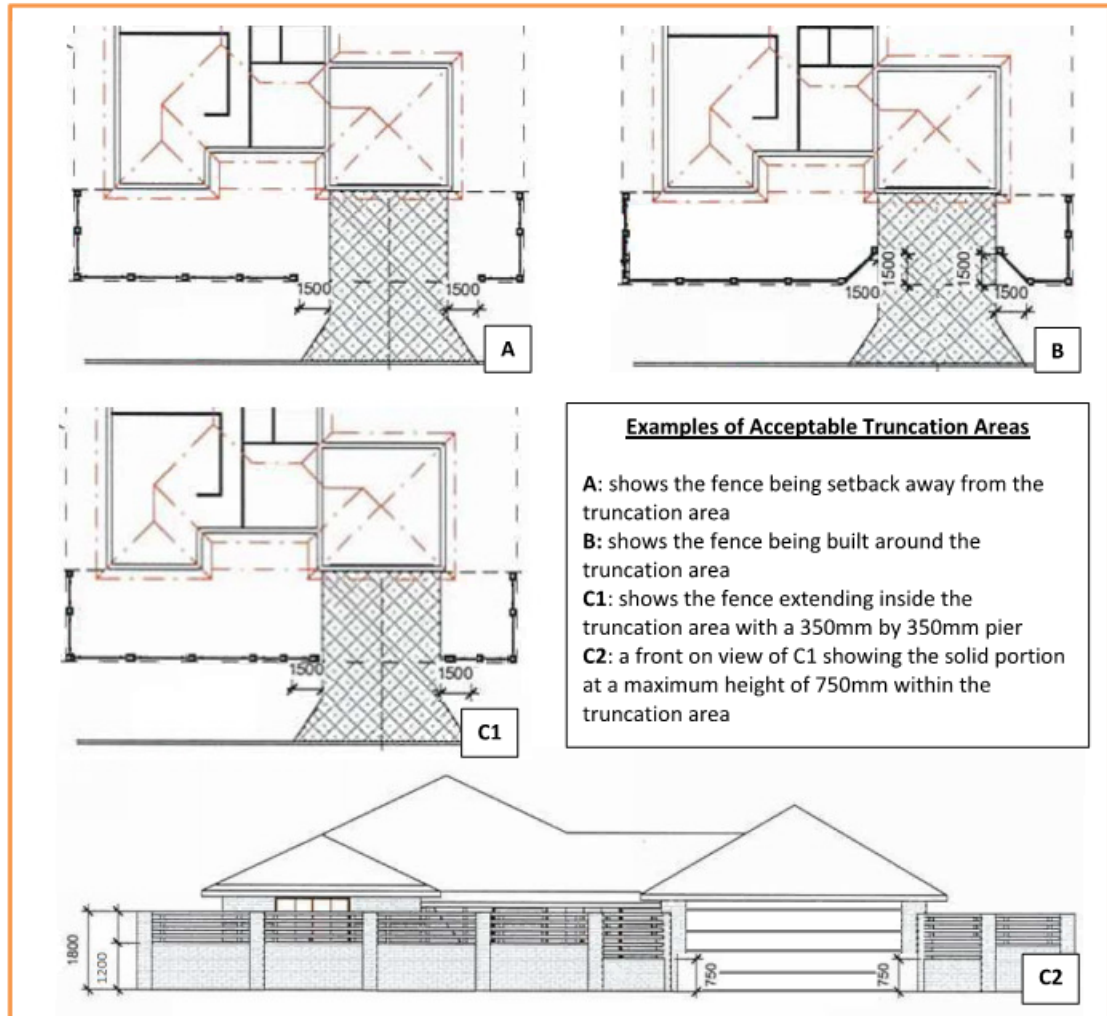

For further information, please contact the City's Building Services on 9439 0417

Disclaimer: The City accepts no responsibility for any ramifications or repercussions in providing this information.